



*Not For Use With Potable Drinking Water Applications

VALVES

SWING CHECK - BRASS
200 WOG/CWP

FEATURES & APPLICATIONS:

- 200 WOG/CWP
- Body; Brass
- Disc; Brass
- Female x Female NPT
- For fluid traveling only in one direction

TECHNICAL DATA:

- **WOG** = Rating indicates the maximum non-shock pressure at ambient temperatures at which the valve may be used.
- **CWP** = Cold working pressure

WOG: Water, Oil & Gas: This was an older, generic pressure rating call-out which has been largely replaced by CWP. In this designation, "GAS" refers to any non-flammable, compressible fluid in a gaseous state. It does not imply a product's suitability or third-party approval for use with flammable gases. Similarly, in this designation, "Oil" does not imply a product's third-party approval for use with any petroleum products.

BRASS

Size	Part #
1/2"	SC 050
3/4"	SC 075
1"	SC 100
1-1/4"	SC 125
1-1/2"	SC 150
2"	SC 200
2-1/2"	SC 250
3"	SC 300
4"	SC 400

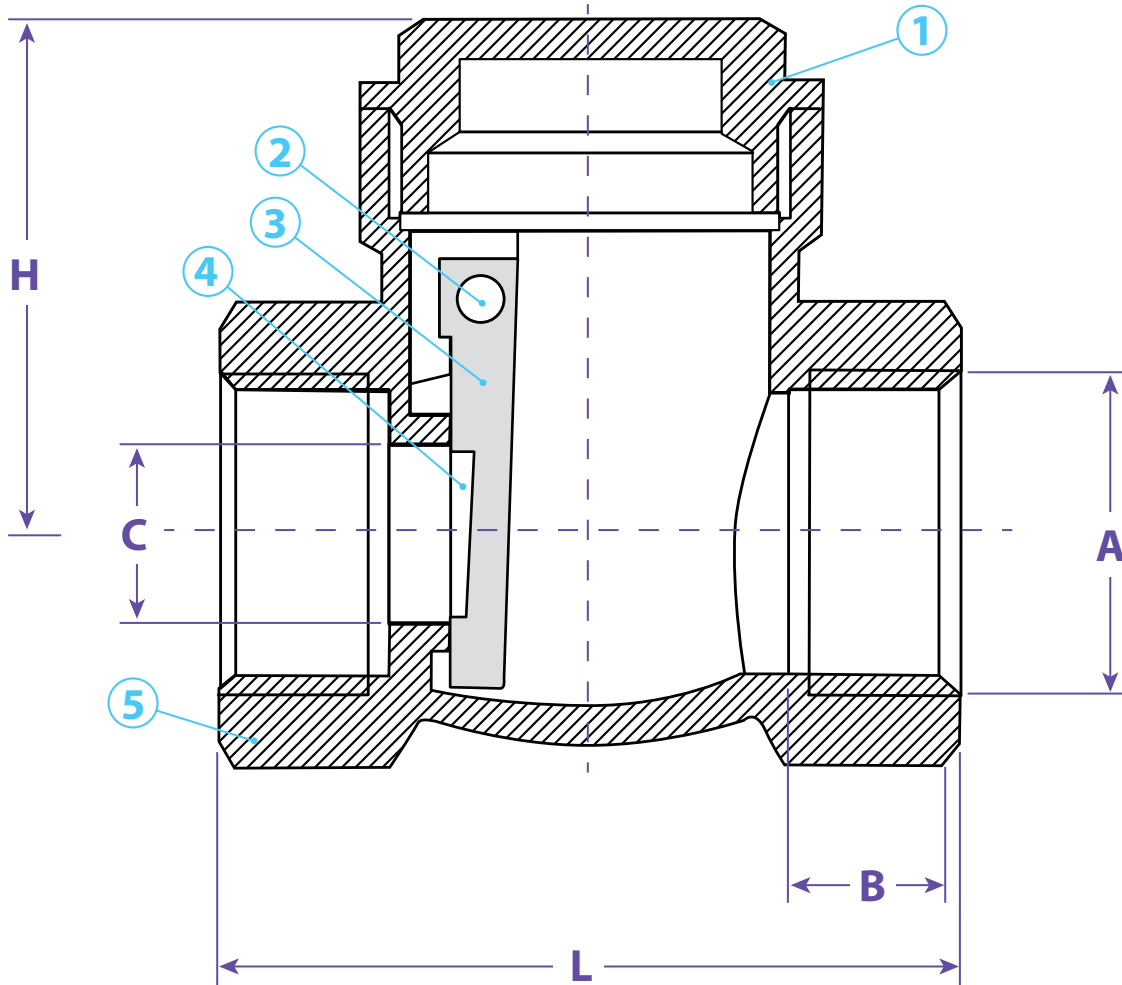

Dimensions						
Size	A	B	C	L	H	Part #
1/2"	1/2"	.39	.51	2.24	1.32	SC050
3/4"	3/4"	.51	.67	2.32	1.44	SC075
1"	1"	.51	.91	2.44	1.71	SC100
1-1/4"	1- 1/4"	.67	1.08	3.07	1.99	SC125
1-1/2"	1- 1/2"	.71	1.28	3.42	2.28	SC150
2"	2"	.94	1.65	4.01	2.52	SC200
2-1/2"	2-1/2"	.79	1.85	5.12	3.19	SC300
3"	3"	.98	2.24	5.91	3.27	SC400
4"	4"	1.02	3.15	6.85	3.94	SC400

Nomenclature & Material		
No.	Description	Material
1	Bonnet	Brass
2	Plug	Brass
3	Pin	Brass
4	Disc	Brass
5	Body	Brass

TITLE **SWING CHECK VALVE**

DISCLAIMER

WOG: Water, Oil & Gas: This was an older, generic pressure rating call-out which has been largely replaced by CWP. In this designation, GAS[™] refers to any non-flammable, compressible fluid in a gaseous state. It does not imply a product's suitability or third-party approval for use with flammable gases. Similarly, in this designation, "Oil" does not imply a product's third-party approval for use with any petroleum products.

MATERIAL

BRASS

DRAWING NOT TO SCALE

PART #

SC...